



"Six Decades of experience and specialization, together with new ideas and the proven reliability of our compressors and compressed air systems."

Founded in **1966**, **PARAMINA SA** deals exclusively with **compressed air**; driven to the **third generation** of ownership as a manufacturer of **high-pressure (420bar max.) piston air compressors, screw air compressors** and **auxiliary compressed air systems** suitable for **Breathing Air** as well as **Industrial applications** in

- Firefighting
- Diving & Medical Engineering
- Defense (air force, navy, army)
- Oil & Gas/H₂S protection
- Marine & Offshore
- Gas Industry (Nitrogen, Helium, Argon)
- Paintball & Shooting Sports
- Motorsports
- Industrial & General-Purpose Air



CERTIFICATES



ACHIEVEMENTS

- Robust Manufacturing based on quality, endurance and low operational cost
- Extensive and specialized knowledge of our engineers
- 3D Mechanical Design & Engineering
- Flexibility
- Personal & Direct approach to all customers
- Instant response to all inquiries
- Short & Prompt deliveries
- Rapid & Immediate service support
- Full availability of all spare parts in stock
- Low priced spare parts
- Custom design solutions according to customers' demands
- Free sales & service training in our facilities for all our partners
- Quality Management system according to EN ISO 9001:2015, certified by TÜV AUSTRIA, for the entire production process, from Research & Development to Manufacturing, Sales and After Sales Services for all our air compressors and air processing equipment. We apply also an environmental system according to EN ISO 14001.
- CE & UKCA declaration of conformity by independent accredited bodies & compliance with EU & UK directives of all our air compressors and air processing equipment.
- IACS approved and certified products for marine industry
- ATEX approved and certified products for Oil & Gas industry
- Compliance with all international standards and regulations in order to reassure the final product quality and user's safety during operation. Paramina's own manufacturing products such as Compressors, Dryers, Filtration Systems, Filling Panels, Storage Systems, Air Quality Control & Measuring Systems, Safety Valves, Filling Valves, Filling Hoses, Pressure Maintaining Valves, are tested ONE by ONE individually, under strict procedures and with the latest pressure testing equipment.
- Product Liability Insurance for all our customers
- Worldwide Sales & Service network

PARAMINA pioneers the first use of an adjusting screw compressor on a tractor (5 m³/min, 8 bar).



PARAMINA commences the production of high pressure breathing air compressors (40-350 bar).

PARAMINA extends its screw compressor series, up to 110 KW.

PARAMINA installs variable speed technology (inverter) to the whole range of screw compressors and develops the most contemporary energy saving systems for any compressed air system installation.

PARAMINA extends its high pressure compressor series, with the new model Cyclone, 24-36 m³/h – 350 bar.

PARAMINA increases the maximum working pressure of its high pressure compressor models Typhoon & Cyclone, up to 420 bar.

New entrance in our product range, Paramina Humidity Control device – including humidity sensor & digital monitoring unit.



PARAMINA celebrates its 50year anniversary

PARAMINA proudly enters deeper in the oil & gas market with our new ATEX Cyclone Silent 24 Electric compressor model 24 m³/h -350bar max, specifically designed for explosive environments

1966 Birth of **PARAMINA**

1973

1981 PARAMINA is the first company in Greece to begin the manufacture of screw compressors.



1995

1997 One of the first Greek Companies, but worldwide as well, to start the quality management procedures for the certification of ISO 9001 and CE.

2002

2003 PARAMINA began with great success to export its products in the international market.



London Dive Show

2004

2005 PARAMINA moves to the new factory aiming to further development of its products and services.



2007

2010 PARAMINA manufactures high pressure refrigerated dryer "CRYO", 36 m³/h – 350bar max.

2012

2013 PARAMINA begins the production of new high pressure piston gas compressors suitable for Nitrogen(N₂), Helium (He), Argon (Ar). Mistral, Typhoon & Cyclone Gas series, from 6.6 m³/h to 36 m³/h – 350bar max.

2014

2015 PARAMINA launches the new "Force" in our high pressure compressor series, Notus model, 10 m³/h – 350bar max.

2016

2019 Newly designed Typhoon compressor models, Tropical series specialized for high ambient temperatures, increased humidity and contaminated environment. Electric & Diesel version, 19,2 m³/h – 350bar max.

2021

2022 PARAMINA introduces new breathing air compressor model Cyclone Classic 24 Diesel, 24 m³/h -350bar max.

"All Mistral M6 models provide the lowest speed rotation of the market, @1200rpm"

MISTRAL is Paramina's "petit" mobile high pressure piston compressor. The unit is 3-staged, air cooled and easy to transport due to the built-in wheels.

MISTRAL provides a reliable source of breathing air due to the unique purification system (a coalescing prefilter installed before the active carbon/molecular sieve cartridge - hopcalite as an option). It is **suitable for private divers, small diving shops, diving boats, yachts and small paintball teams**.

MISTRAL's very low turning speed accomplishes low noise level, almost zero vibration and ensures long life operation.

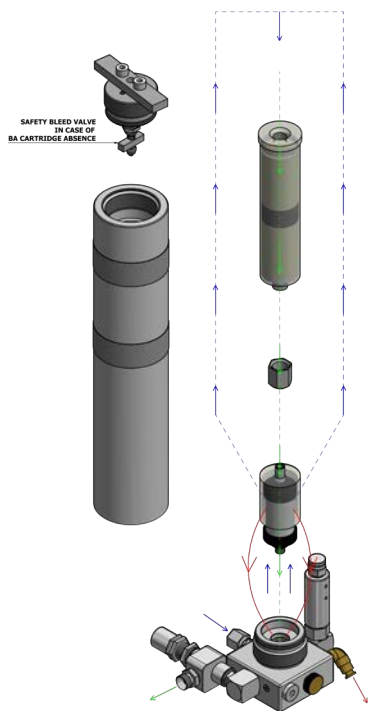

Combined Breathing Air Filter
Ø 80x375



M6/M8 - EM/ET



Technical Data

Model	Power	Max. Pressure	FAD		RPM	Dimensions cm			Weight Kg
		bar	m³/h	lit/min		L	W	H	
M6-BZ	3.6kW 4stroke petrol	350	6.2	103	1200	88	41	51	55-65
M6-EM	2.2kW/220-230V/50-60Hz	350	6.2	103	1200	78	41	49	53-73
M6-ET	2.2kW/400-440V/50-60Hz	350	6.2	103	1200	78	41	49	53-73
M8-BZ	4.1kW 4stroke petrol	350	8.4	140	1750	88	41	51	65-73
M8-EM	3.7kW/220-230V/50-60Hz	350	8.4	140	1750	78	41	49	67-85
M8-ET	3kW/400-440V/50-60Hz	350	8.4	140	1750	78	41	49	67-85

- Oil capacity: 500ml special synthetic compressor oil.
- Permissible ambient temperature: +5 °C to +45 °C.
- ◆ Optional: Classic Version (LxWxH: 94x53x70 cm, 118 kg).



Adaptor DIN 300
to DIN 200
(optional)



Classic ET

Design Specifications

	M6-EM, M8-EM, M6-ET, M8-ET	M6-BZ, M8-BZ
Start/Stop switch	●	■
Micronic air inlet filter	●	●
Pressure maintaining & non return valve for extended filtration	●	●
Condensate Separator after 2nd Stage	●	●
Combined BA Filter including Coalescing Pre-filter (0.5 mg/m ³ oil residual) and B.A. cartridge (AC/MS + HP option), with the supply of absolutely clean air exceeding by far the requirements of EN12021	●	●
Safety Bleed valve in case of BA Cartridge absence	◆	◆
Large Stainless Steel Intercoolers - Aftercooler	●	●
Safety Valves in all stages	●	●
Kevlar filling hose (1.2m) with stainless steel fittings and DIN/INT'L connector	●	●
Electric hourmeter	●	■
Vibration hourmeter/service timer (Running hours, BA filter/oil service hours)	◆	●
Final stage Manometer	●	●
Manual condensate drains	●	●
Motor thermal overload protection	●	■
Automatic belt tensioning system	●	●
Automatic stop system	◆	◆
Automatic start system	◆	■
Automatic condensate drains with manual backups	◆	■
Dual pressure filling facility, allowing 225/330 bar alternative filling	◆	◆
Condensate collecting tank	◆	■
1.5m air inlet hose with particle strainer	◆	●
Special voltage/frequency: 3 x 230 V/ 60 Hz - 110 V / 60 Hz	●	■

● Standard | ◆ Optional | ■ Not Applicable

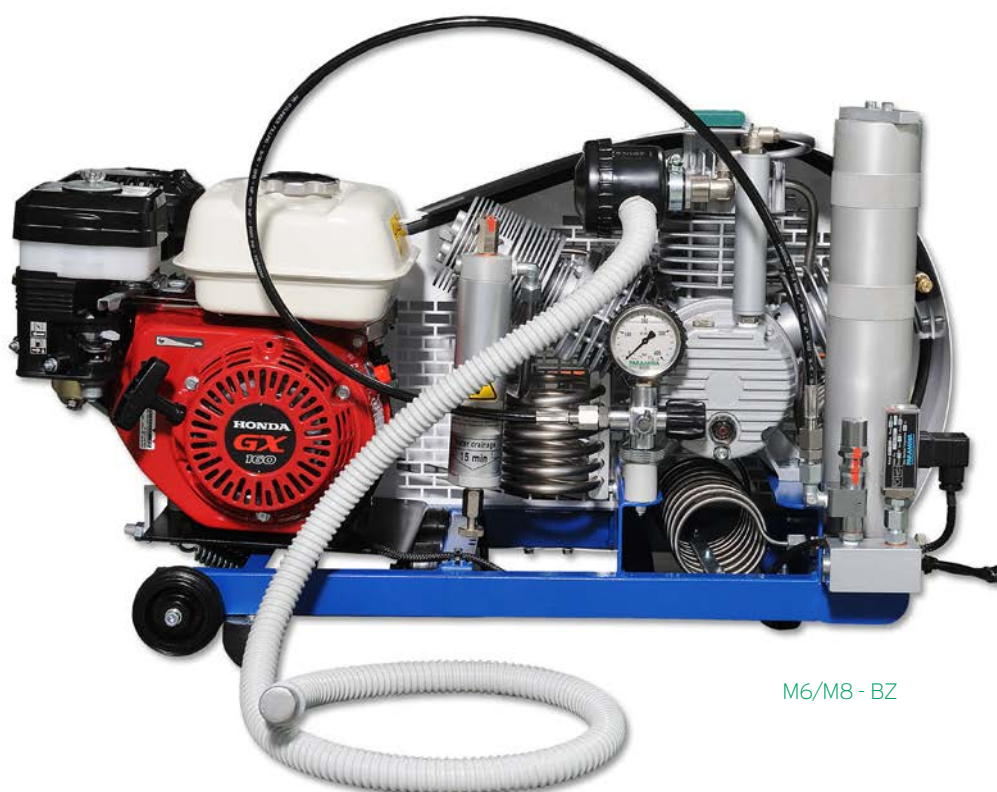

M6/M8 - BZ

*“Notus Classic models
provide
fully automated
versions
as an option”*

NOTUS, Paramina's new “Force” in high pressure piston compressor series. Heavy duty design for continuous operation during the day, easy-to-move, 3-staged, oil lubricated and air cooled, offering pure breathing air according to EN 12021.

NOTUS is suitable for indoor or open area installations, mobile rescue squads, fire trucks, diving boats & paintball teams. Its robust construction makes it suitable for several industrial applications as well.

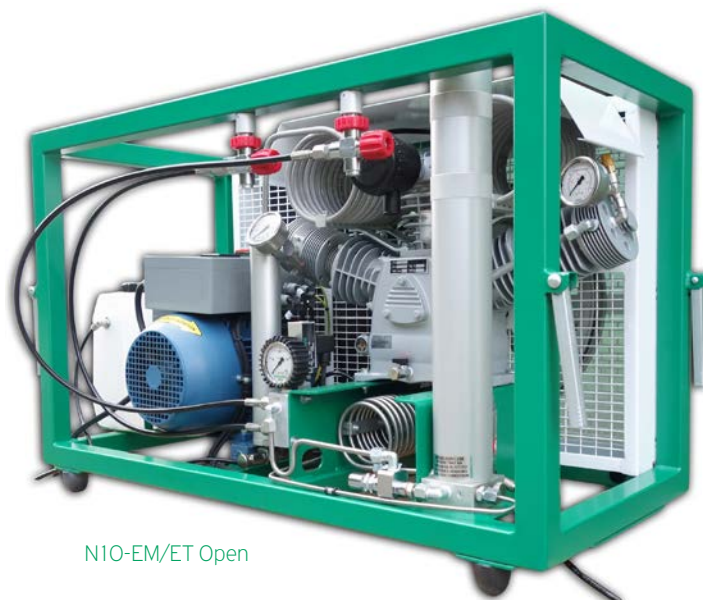

N10-EM/ET Open



N10-ET Classic

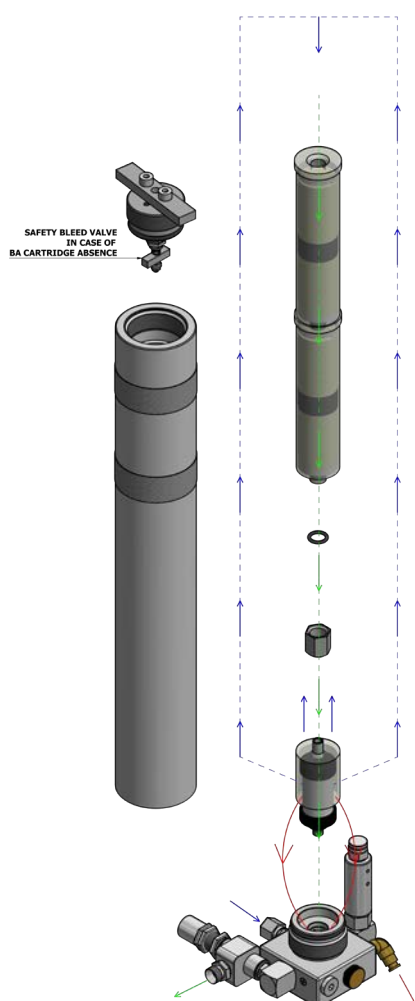

Combined Breathing Air Filter
Ø 80x560

Technical Data

Model	Power	Max. Pressure	FAD		RPM	Dimensions cm			Weight Kg
		bar	m³/h	lit/min		L	W	H	
N10-EM Open	3.7kW/220-230V/50-60Hz	350	10.2	170	1400	110	53	68	113-128
N10-ET Open	4kW/400-440V/50-60Hz	350	10.2	170	1400	110	53	68	129-135
N10-ET Classic	4kW/400-440V/50-60Hz	350	10.2	170	1400	115	53	74	149-155
N10-BZ Open	4.1kW 4stroke petrol	350	10.2	170	1400	110	53	68	86

- Oil capacity: 1.2 lit special synthetic compressor oil.
- Permissible ambient temperature: +5 °C to +45 °C.

Design Specifications

	N10-EM Open	N10-ET Open	N10-ET Classic	N10-BZ Open
Micronic Air Inlet Filter	●	●	●	●
Condensate Separator after 2nd Stage	●	●	●	●
Large Stainless Steel Intercoolers - Aftercooler in all stages	●	●	●	●
Combined BA Filter including Coalescing Pre-filter (0.5mg/m3 oil residual) and 2 x BA cartridges (AC/MS + HP option), with the supply of absolutely clean air exceeding by far the requirements of EN 12021	●	●	●	●
Safety Bleed valve in case of BA Cartridge absence	◆	◆	◆	◆
Pressure maintaining & non-return valve for extended filtration	●	●	●	●
Start/Stop switch	●	●	●	■
Motor thermal overload protection	●	●	●	■
Manual Condensate Drains	●	●	●	●
Kevlar filling hose (1.2m) with stainless steel fittings and DIN/INT'L connector	●	●	●	●
Handles for easy lifting	●	●	■	●
Safety Valves in all stages	●	●	●	●
Final Stage manometer	●	●	●	●
Automatic belt tensioning system	●	●	●	●
Electric hourmeter	●	●	●	■
Vibration hourmeter / service timer (Running hours, BA filter / oil service hours)	◆	◆	◆	●
Automatic stop system	◆	◆	◆	◆
Automatic start system	◆	◆	◆	■
Automatic condensate drains with manual backups + Condensate collecting tank.	◆	◆	◆	■
Dual pressure filling facility, allowing 225/330bar alternative filling	◆	◆	◆	◆
Star/Delta starter system	■	■	◆	■
Low oil level monitoring / alarm / shutdown	■	■	◆	■
High temperature monitoring / alarm / shutdown	■	■	◆	■
24VAC secondary voltage providing safety during routine operation	■	■	◆	■
Emergency Stop button	■	■	●	■
Main Switch	■	■	●	■
Remote start/stop	■	■	◆	■
Condensate separator after 3rd (final) stage	◆	◆	◆	◆
Interstage manometers	●	●	●	●
1.5m air inlet hose with particle strainer	◆	◆	◆	●
Special voltage/frequency 3x230V/60Hz * 460-480V/60Hz	■	■	◆	■

● Standard | ◆ Optional | ■ Not Applicable



N10-BZ Open

"All Typhoon Electric versions provide automatic stop & automatic condensate drain facility as standard equipment."

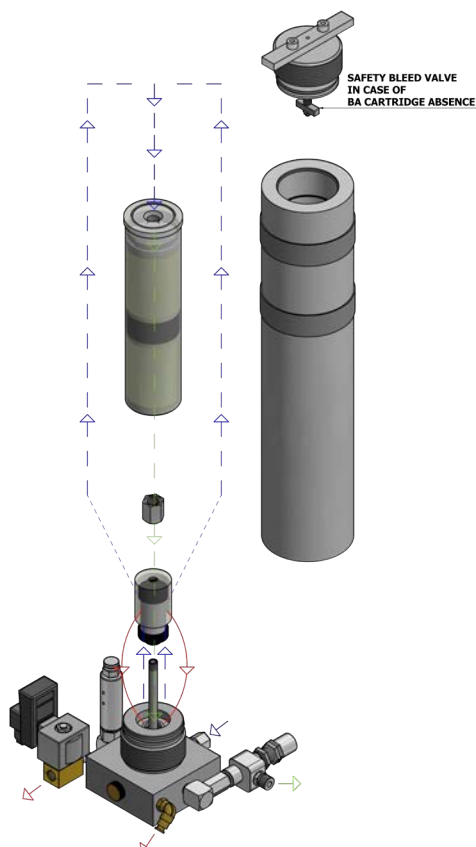

TYPHOON series, 3-staged, air-cooled, high pressure piston compressor, comprising of 15 standard models, with very low turning speed and pure breathing air according to EN 12021, making it **a perfect solution for any breathing air, paint-ball or industrial application**; i.e. fire rescue teams, military units, diving shops, paintball clubs and others.

The series consists of three versions:

- **Open Framed Portable** - With the option of electric motor, petrol and diesel engine for exterior use.
- **Classic Stationary** - With the option of electric motor.
- **Silent** - With soundproof insulation enabling it to operate in areas where the noise level is of issue. Includes digital control panel driving, controlling, protecting and ensuring the safe operation of the compressor.

Technical Data

Model	Power	Max. Pressure	FAD		RPM	Dimensions cm			Weight Kg
		bar	m³/h	lit/min		L	W	H	
Silent 15E *	5.5kW/400-440V/50-60Hz	350/420	15	250	1100	80	98	118	244-260
Silent 18E *	7.5kW/400-440V/50-60Hz	350/420	18/19	300/320	1290/1380	80	98	118	263-269
Open 15E *	5.5kW/400-440V/50-60Hz	350	15	250	1100	109	54	71	185-191
Open 18E	7.5kW/400-440V/50-60Hz	350	18/19	300/320	1290/1380	109	54	71	187-211
Classic 15E	5.5kW/400-440V/50-60Hz	350/420	15	250	1100	71	125	78	216-232
Classic 18E	7.5kW/400-440V/50-60Hz	350/420	18/19	300/320	1290/1380	71	125	78	226-247
Twin 15E	2x5.5kW/400-440V/50-60Hz	350	2x15	2x250	1100	134	63	172	421-437
Twin 18E	2x7.5kW/400-440V/50-60Hz	350	2x18	2x300	1300	134	63	172	436-456

- Oil capacity: 2.2 lit special synthetic compressor oil.
- Permissible ambient temperature: +5 °C to +45 °C.
- Noise level: Silent 15E - 69 dB(A) @1m, Silent 18E - 70 dB(A) @1m.
- ★ **NEW Economy Versions: Open 13ES, Open 15ES, Silent 15ES, Silent 18ES.**



Silent



Design Specifications

	Open/ Classic 15E, 18E	Silent 15E, 18E	Twin 15,18E
Star/Delta starter system	● ¹	● ¹	●
Advanced DIGITAL CONTROLLER providing operation (running hrs, filling pressure, operating temperature), control (start/stop/reset/menu button) & service (service hrs-alarm, records of the last 15 malfunctions) data	■	●	■
Oil pump lubrication	◆	◆	◆
Start/Stop switch	●	■	●
Motor thermal overload protection	●	●	●
Automatic stop system	●	●	●
Automatic start system	◆	●	◆
Automatic condensate drains with manual backups + Condensate collecting tank.	●	●	●
24V secondary voltage providing safety during routine operation	●	●	●
Emergency Stop button	●	●	●
Micronic air inlet filter	●	●	●
Pressure maintaining & non return valve for extended filtration	●	●	●
Condensate Separator after 2nd Stage	●	●	●
Combined BA Filter including Coalescing Pre-filter (0.5 mg/m ³ oil residual) and BA cartridge (AC/MS + HP option), with the supply of absolutely clean air exceeding by far the requirements of EN12021	● ²	● ²	● ²
Safety Bleed valve in case of BA Cartridge absence	◆	◆	◆
Large Stainless Steel Intercoolers - Aftercooler	●	●	●
Safety Valves in all stages	●	●	●
Interstage pressure sensors providing emergency shutdown in case of overpressure	◆	●	◆
2 Kevlar filling hoses (1.2m each) with stainless steel fittings and DIN/INT'L connectors	●	●	■
Lever operated on/off filling valves with automatic ventilation	◆	●	■
Soundproof insulation ensuring very low noise level	■	●	■
Dual pressure filling facility, allowing 225/330 bar simultaneous filling via pressure regulator	◆	◆	■
Remote Start/Stop - Remote Load/Unload	◆	●	◆
Interstage/Final stage Manometers	●	●	●
Electric hourmeter	●	●	●
Vibration hourmeter/service timer (Running hours, BA filter/oil service hours)	◆	■	◆
High Temperature monitoring / alarm / shutdown	◆	●	◆
Low Oil level monitoring / alarm / shutdown	◆	◆	●
Carbon Monoxide (CO) monitoring / alarm / shutdown system	◆	◆	◆
Hydrogen Sulfide (H ₂ S) monitoring / alarm / shutdown system	◆	◆	◆
Humidity (H ₂ O) monitoring / alarm / shutdown system	◆	◆	◆
Carbon Dioxide (CO ₂) monitoring / alarm / shutdown system	◆	◆	◆
OIL-VOC monitoring / alarm / shutdown system	◆	◆	◆
Final stage Condensate Separator	◆	◆	◆
Special Voltage/Frequency: 230V/50Hz-60Hz * 3x230V/60Hz * 460-480V/60Hz	◆	◆	◆
Voltage failure and Phase Rotation Safety device	◆	◆	◆
Automatic belt tensioning system	●	●	●
1.5m air inlet hose with particle strainer	◆	◆	◆

● Standard | ◆ Optional | ■ Not Applicable

¹ Standard on Typhoon 18 models - option on Typhoon 15 models.

² Ø80 x 560 Typhoon 15 models,
Ø110 x 495 Typhoon 18 models
(option for Typhoon 15 models).
Ø110 x 725 Typhoon Twin 15E & 18E.



Twin

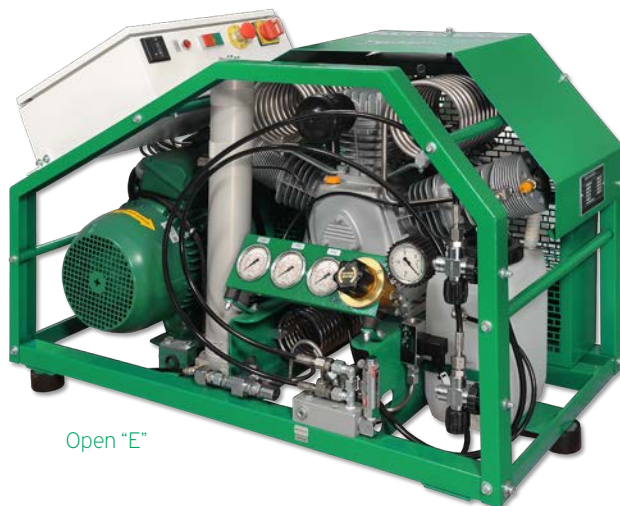

Open "E"



Classic

*"All Typhoon
Petrol & Diesel versions
provide
electric starting system
as standard equipment"*

Technical Data

Model	Power	Max. Pressure	FAD		RPM	Dimensions cm			Weight
		bar	m³/h	lit/min	min ⁻¹	L	W	H	Kg
Open 15D	6.8kW Diesel	350	15	250	1100	128	52	73	198-210
Open 15P	6.3kW 4stroke Petrol	350	15	250	1100	128	52	73	169-174
Open 18P	8.7kW 4stroke Petrol	350	18	300	1300	128	52	73	187-192

- Oil capacity: 2.2 lit special synthetic compressor oil.
- Permissible ambient temperature: +5 °C to +45 °C.

Design Specifications

	Open 15P, 18P, 15D
Electric Starter/Battery fitted	•
Oil pump lubrication	◆
Automatic stop system	◆
Automatic condensate drains with manual backups + Condensate collecting tank.	◆
Micronic air inlet filter	•
Pressure maintaining & non return valve for extended filtration	•
Condensate Separator after 2nd Stage	•
Combined BA Filter including Coalescing Pre-filter (0.5 mg/m³ oil residual) and BA cartridge (AC/MS + HP option), with the supply of absolutely clean air exceeding by far the requirements of EN12021	• ¹
Safety Bleed valve in case of BA Cartridge absence	◆
Large Stainless Steel Intercoolers - Aftercooler	•
Safety Valves in all stages	•
2 Kevlar filling hoses (1.2m each) with stainless steel fittings and DIN/INT'L connectors	•
Dual pressure filling facility, allowing 225/330 bar simultaneous filling via pressure regulator	◆
Interstage/Final stage Manometers	•
Vibration hourmeter/service timer (Running hours, BA filter/oil service hours)	•
High Temperature monitoring / alarm / shutdown system	◆
Low Oil level monitoring / alarm / shutdown system	◆
Carbon Monoxide (CO) monitoring / alarm / shutdown system	◆
Hydrogen Sulfide (H ₂ S) monitoring / alarm / shutdown system	◆
Humidity (H ₂ O) monitoring / alarm / shutdown system	◆
Carbon Dioxide (CO ₂) monitoring / alarm / shutdown system	◆
OIL-VOC monitoring / alarm / shutdown system	◆
Final stage Condensate Separator	◆
Automatic belt tensioning system	•
1.5m air inlet hose with particle strainer	•

• Standard | ◆ Optional

¹ Ø80 x 560 Typhoon 15 models, Ø110 x 495 Typhoon 18 models (option for Typhoon 15 models).



Petrol

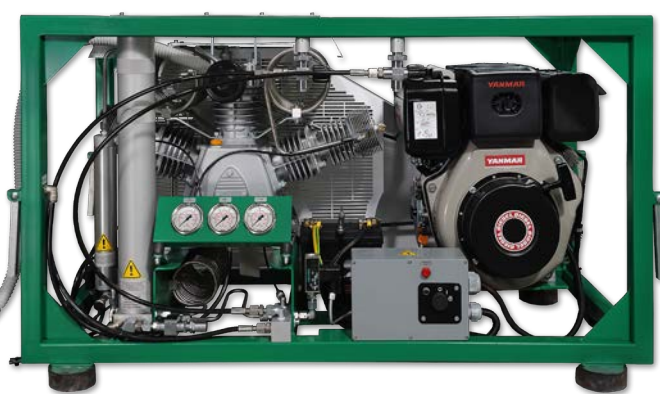

Diesel

PARAMINA Breathing Air System

Pure Breathing Air exceeding EN12021 & International Standards

- Air Compressor producing high pressure breathing air up to 420 bar max with capacities from 103 lit/min up to 600 ltr/min.
- Refrigerated Air Dryer drying compressed air down to 3 °C dew point before entering the BA Filters, thus increasing BA cartridges lifetime and reducing compressor's service costs.
- BA Filtration Systems (Active Carbon / Molecular Sieve / Hopcalite + coalescing prefilter 0,5 mg/m³) ensuring best breathing air quality – custom design availability.
- Automatic Filling System giving priority to BA cylinders filling either from the Compressor or the Storage System.
- Storage System with reverted cylinders for no moisture accumulation at their bottom, at any pressure and number of cylinders combination – custom design availability.
- Air Quality Control Systems for continuous monitoring & alarm of O₂, CO, CO₂, H₂O, VOC (Oil) & H₂S limits, reassuring premium inhaled compressed air.
- Wall-mounted filling panels at any pressure and number of filling hoses combination – custom design availability.



"All Typhoon Tropical models are designed for high ambient temperatures (50 °C) & increased humidity environment"

Typhoon Tropical series, 3-staged/air-cooled/high pressure piston compressor, ensuring safe operation and pure breathing air quality acc. to EN 12021 directive, even in contaminated environment via CO, H₂S, H₂O monitoring and alarm.

- Heavy Duty Design.
- Extreme Operating Conditions.

Technical Data

Model	Power	Max. Pressure	FAD		RPM	Dimensions cm			Weight
		bar	m³/h	lit/min		L	W	H	Kg
Classic 18E TROPICAL	9.2kW/400-440V/50-60Hz	350	19.2	320	1370	152	81	107	339
Classic 18D TROPICAL	11.2kW Diesel	350	19.2	320	1370	142	74	102	398

- Oil capacity: 2.3 lit special synthetic compressor oil.
- Permissible ambient temperature: +5 °C to +50 °C.

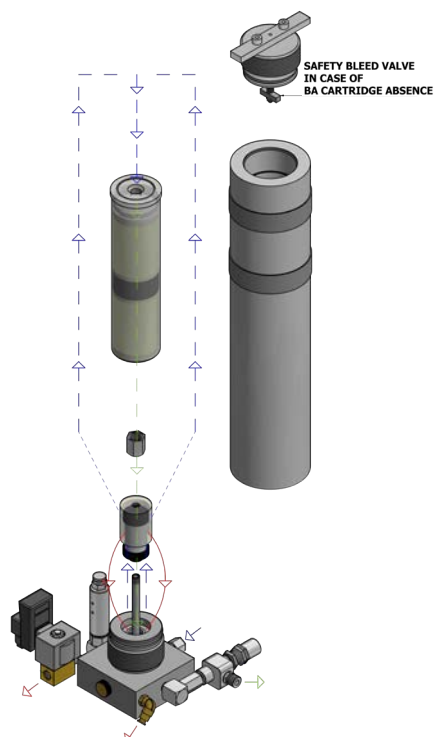

Combined Breathing Air Filter
Ø 110 x 495



CLASSIC 18
ELECTRIC TROPICAL



CLASSIC 18
DIESEL TROPICAL



Dual Pressure
200 & 300 bar Filling

Design Specifications

	Classic 18E TROPICAL	Classic 18D TROPICAL
Star/Delta starter system	●	■
Electric Starter/Battery fitted	■	●
Advanced DIGITAL CONTROLLER providing operation (running hrs, filling pressure, operating temperature), control (start/stop/reset/menu button) & service (service hrs-alarm, records of the last 15 malfunctions) data	◆	■
Oil pump lubrication	◆	◆
Lifting eyebolts for easier transportation	●	●
Galvanized & powder Coated frame and covers	●	●
Electric Hourmeter	●	■
Vibration hourmeter/service timer (Running hours, BA filter/oil service hours)	◆	●
Voltage Failure & Phase Rotation Safety Device	●	■
Start/Stop switch	●	●
Motor thermal overload protection	●	■
Automatic stop system	●	●
Automatic start system	◆	■
Automatic condensate drains with manual backups	●	●
24V secondary voltage providing safety during routine operation	●	■
Emergency Stop button	●	■
Micronic air inlet filter	●	●
Pressure maintaining & non return valve for extended filtration	●	●
Condensate Separators in all stages	●	●
Combined BA Filter including Coalescing Pre-filter (0.5 mg/m3 oil residual) and BA cartridge (AC/MS + HP option), with the supply of absolutely clean air exceeding by far the requirements of EN12021	●	●
Safety Bleed valve in case of BA Cartridge absence	◆	◆
Large Stainless Steel Intercoolers - Aftercooler	●	●
Safety Valves in all stages	●	●
Interstage pressure sensors providing emergency shutdown in case of overpressure	◆	■
2 Kevlar filling hoses (1.2m each) with stainless steel fittings and DIN/INT'L connectors	●	●
Lever operated on/off filling valves with automatic ventilation	●	●
Dual pressure filling facility, allowing 225/330 bar simultaneous filling via pressure regulator	◆	◆
Remote Start/Stop - Remote Load/Unload	◆	■
Interstage/Final stage Manometers	●	●
High Temperature monitoring / alarm / shutdown	●	●
Low Oil level monitoring / alarm / shutdown	●	●
Carbon Monoxide (CO) monitoring / alarm / shutdown system	◆	◆
Hydrogen Sulfide (H ₂ S) monitoring / alarm / shutdown system	◆	◆
Humidity (H ₂ O) monitoring / alarm / shutdown system	◆	◆
Carbon Dioxide (CO ₂) monitoring / alarm / shutdown system	◆	◆
OIL-VOC monitoring / alarm / shutdown system	◆	◆
Condensate collecting tank	●	●
Special Voltage/Frequency: 230V/50Hz-60Hz * 3x230V/60Hz * 460-480V/60Hz	◆	■
Automatic belt tensioning system	●	●
1.5m air inlet hose with particle strainer	◆	●

● Standard | ◆ Optional | ■ Not Applicable

"All Cyclone models are fully automated and provide 4-stages compression"

CYCLONE, the Silent Force. **4-staged, air cooled, high pressure piston compressor**, combining low turning speed operation, soundproof insulated doors, optimum cooling system, and easy-to-use digital control panel, providing smooth, safe, quiet and long life operation. Easy access through large openings ensuring quick maintenance.

The multi stage purification system guarantees absolute clean air, making it **applicable in** numerous breathing air sectors including **fish farms, military, fire brigades** and **diving centers**.

Technical Data

Model	Power	Max. Pressure	FAD		RPM	Dimensions cm			Weight
		bar	m³/h	lit/min		L	W	H	
Silent 24E *	7.5kW/400-440V /50-60Hz	350/420	24	400	700	81	124	178	498-510
Classic 24D	11,2kW Diesel	350	24	400	700	169	94	113	560-570
Silent 30E	11kW/400-440V /50-60Hz	350/420	30	500	900	81	124	178	549-556
Silent 36E	15kW/400-440V /50-60Hz	350/420	36	600	1000	81	124	178	551-585

- Oil capacity: 2.1 lit special synthetic compressor oil.
- Permissible ambient temperature: +5 °C to +45 °C.
- Noise level: C. Silent 24 - 72 dB(A) @1m, C. Silent 30 - 73 dB(A) @1m, C. Silent 36 - 75 dB(A) @1m.
- * ATEX version exclusively designed for explosive environments.

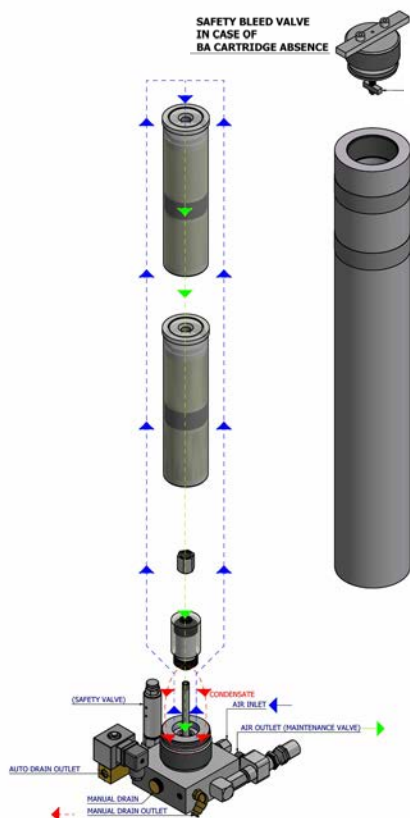

Combined Breathing Air Filter
Ø 110 x 725



Silent "E"

Design Specifications

	SILENT 24E,30E,36E	CLASSIC 24D	
Star/Delta starter system	●	■	
Electric Starting system with starter	■	●	
Advanced DIGITAL CONTROLLER providing operation (running hrs, filling pressure, operating temperature), control (start/stop/reset/menu button) & service (service hrs-alarm, records of the last 15 malfunctions) data	●	■	
Oil pump lubrication	◆	◆	
Automatic stop system at the desirable pressure	●	●	
Vibration Hourmeter / Service Timer (running Hours, BA Filter / Oil service hours)	■	●	
Automatic condensate drains with manual backups + Condensate collecting tank	●	●	
24V secondary voltage providing safety during routine operation	●	■	
Main Switch & Emergency Stop button	●	■	
Micronic air inlet filter	●	●	
1,5m air inlet hose with particle strainer	◆	●	
Pressure maintaining & non return valve for extended filtration	●	●	
Condensate Separators after 1st, 2nd, 3rd and final stage	●	●	
Combined BA Filter including Coalescing Pre-filter (0.5 mg/m3 oil residual) and 2 large BA cartridges (AC/MS + HP option), with the supply of absolutely clean air exceeding by far the requirements of EN12021	●	●	
Safety Bleed valve in case of BA Cartridge absence	◆	◆	
High efficiency aluminium Intercooler (1st & 2nd stage)	●	■	
Large Stainless Steel Intercooler (1st & 2nd stage)	■	●	
Large Stainless Steel Intercooler - Aftercooler (3rd & 4th stage)	●	●	
Safety Valves in all stages	●	●	
Interstage pressure sensors providing emergency shutdown in case of overpressure	●	■	
Secondary large fan with independent electric motor for optimum cooling (630mm diam.)	●	■	
5 Kevlar filling hoses (1.2m each) with stainless steel fittings and DIN/INT'L connectors	●	●	
Lever operated on/off filling valves with automatic ventilation	●	●	
Soundproof insulation ensuring very low noise level	●	■	
Dual pressure filling facility, allowing 225/330 bar simultaneous filling via pressure regulator	◆	◆	
Remote Start/Stop - Remote Load/Unload	●	■	
Interstage/Final stage Manometers	●	●	
High Temperature monitoring / alarm / shutdown	●	●	
Low Oil level monitoring / alarm / shutdown	●	●	
Special Voltage/Frequency: 230V/50-60Hz * 3x230V/60Hz * 460-480V/60Hz	◆	■	
Voltage failure and Phase Rotation Safety device	◆	■	
Automatic belt tensioning system	●	●	
Carbon Monoxide (CO) monitoring / alarm system / shutdown system	◆	◆	
Hydrogen Sulfide (H2S) monitoring / alarm / shutdown system	◆	◆	
Humidity (H2O) monitoring / alarm system / shutdown system	◆	◆	
Carbon Dioxide (CO2) monitoring / alarm / shutdown system	◆	◆	
OIL-VOC monitoring / alarm / shutdown system	◆	◆	

■ Not Applicable
 —
 ◆ Optional
 —
 ● Standard



Classic Diesel

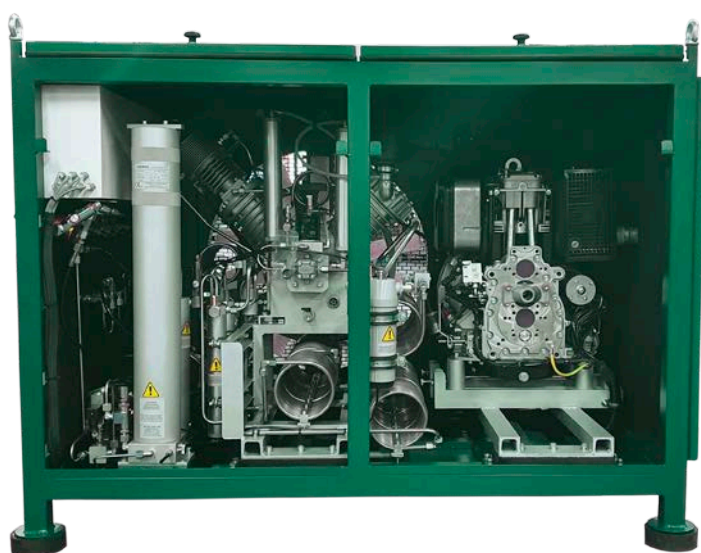

*“Tailor-made
solutions
for each
individual Gas
installation”*

High-pressure piston **GAS** compressors, suitable for **NITROGEN (N₂)**, **Helium (He)** & **Argon (Ar)** applications; Compact or Silent, 3+4-staged, air cooled, oil lubricated, with Zero Loss drain system.

Technical Data

Model	Power	Max. Pressure	FAD		Dimensions cm			Weight
		bar	m ³ /h	lit/min	L	W	H	Kg
Mistral M6-ET Classic	2.2kW/400-440V/50-60Hz	350	6.6	110	94	55	70	120
Notus N10-ET Classic	4kW/400-440V/50-60Hz	350	10.2	170	110	55	68	146
Typhoon Classic 18E	7.5kW/400-440V/50-60Hz	350	19.2	320	71	125	78	250-261
Typhoon Silent 18E	7.5kW/400-440V/50-60Hz	350	19.2	320	80	98	118	280
Cyclone Silent 30E	11kW/400-440V/50-60Hz	350	30	500	81	124	178	567-582
Cyclone Silent 36E	15kW/400-440V/50-60Hz	350	36	600	81	124	178	594-603



Mistral
Gas



Notus Gas

Design Specifications

Inlet Solenoid valve
Inlet Pressure regulator
2 x Inlet pressure safety valves
Inlet Pressure Manometer
Inlet Pulsation chamber
Inlet Safety Pressure Switch
Inlet Vacuum Safety Pressure Switch
Oversized Stainless Steel Intercoolers & Aftercooler in all stages for optimum cooling
Advanced Design Cylinder Heads for optimum heat discharge
Safety Valves in all stages
Interstage and Final stage Condensate Separators
Final Gas Purification Filter, including coalescing prefilter (0.5 mg/m ³ oil residual) and 2x large AC/MS cartridges
Large fan for high efficiency cooling of cylinders, intercoolers & aftercoolers, making the compressor capable for continuous operation
Secondary fan with independent electric motor for extra cooling (available only for Cyclone Silent model)
Zero Loss Automatic Condensate Drain system via condensate return piping system, back inside compressor's crankcase
Star/Delta starter system
24V secondary voltage providing safety during routine operation
Main Switch
Emergency Stop button
Advanced DIGITAL CONTROLLER (available only for Typhoon Silent and Cyclone Silent models)
Automatic Start/Stop system at the desirable pressure
Interstage pressure control with pressure sensors in all stages (available only for Typhoon Silent and Cyclone Silent models)
High temperature alarm & shutdown error
Oil pump lubrication (Optional)
Low Oil level sensor alarm & shutdown error
Hourmeter
Motor thermal overload protection
Voltage failure and Phase Rotation Safety device
Interstage and Final Stage Manometers
Built-In Vibration Pads
Non return valve before the outlet
Automatic belt tensioning system
Soundproof insulation (available only for Typhoon Silent and Cyclone Silent models)



Typhoon Gas



Cyclone Gas



MIDDLE PRESSURE COMPRESSORS

Middle-pressure piston compressors, suitable for any INDUSTRIAL application; Open Framed, 2-staged, air cooled, oil lubricated.
Models: Mistral & Typhoon.

Technical Data

Model	Power	Max. Pressure	FAD		Dimensions cm			Weight
		bar	m³/h	lit/min	L	W	H	Kg
Mistral M6-ET 40b	2.2kW/400-440V/50-60Hz	40	10	166	74	40	48	60
Typhoon Open 15E 40b	5.5kW/400-440V/50-60Hz	40	24	400	109	54	71	185-190
Typhoon Open 18E 40b	7.5kW/400-440V/50-60Hz	40	30	500	109	54	71	190-195

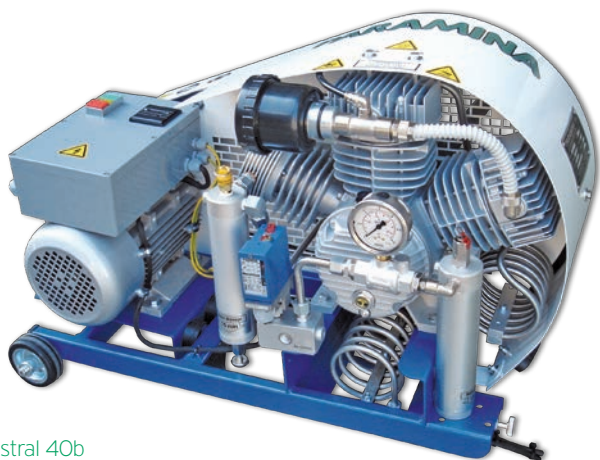

Mistral 40b

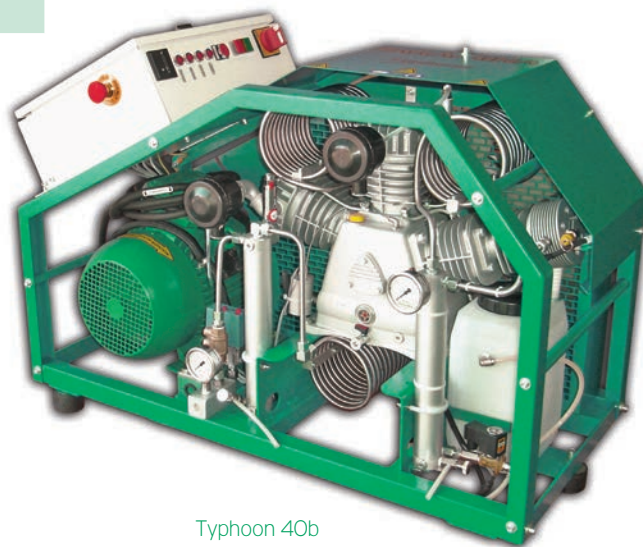

Typhoon 40b

REFRIGERATED DRYER "CRYO"

HPRD 600

Model	Power	Max. Working Pressure	Capacity		Dimensions cm			Weight
		bar	m³/h	lit/min	L	W	H	Kg
HPRD600	230V AC / 50-60Hz	350/420	36	600	53	58	48	43

- +3 °C dew point.
- R134a CFC Free refrigerant.



HUMIDITY CONTROL SYSTEM

Model	Power	Max. Working Pressure	Dimensions cm			Weight
		bar	L	W	H	Kg
HC	230VAC 50-60Hz or 24VAC 50-60Hz or 24VDC	420	12.3	20	11.2	2.2

- Accurate humidity sensor in stainless steel chamber.
- Central monitoring unit with digital display.



HC

STORAGE SYSTEMS

- Powder coated steel frame
- 50/80 lit. Cylinders
- Working Pressure up to 450 bar
- Custom design availability
- Reverted cyclinders for no moisture accumulation at their bottom



FILTRATION SYSTEMS

- Wall mounted powder coated steel frame
- BA Filter(s) (Coalescing Prefilter & BA cartridges)
- Manual and/or Automatic condensate drains



FILLING PANELS

- Breathing air filling panels
- Automatic priority filling panels
- Paintball filling panels
- Custom design availability



- Kevlar filling hoses with lever operated filling valves
- Dual pressure filling facility 225/330 bar
- Wall mounted powder coated steel frame



KEVLAR
FILLING
HOSES

DIN200/300
FILLING
CONNECTORS &
YOKE ADAPTORS



LEVER
FILLING
VALVES



PRESSURE
MAINTAINING
VALVES



SAFETY
VALVES





We are proud of our consistent

- ✓ Product Quality
- ✓ Experience
- ✓ Specialization
- ✓ Reliability

*now spanning over **56 years!***

FIND US ONLINE



0437



PARAMINA SA

Byway Evagelistrias str., 19300 Aspropirgos, Greece
Tel: +30 210 5575860-1

www.paramina-compressors.com | info@paramina.gr

f [paramina.compressors](https://www.facebook.com/paramina.compressors) | **@** [paramina_aircompressors](https://www.instagram.com/paramina_aircompressors)
in PARAMINA Air Compressors Manufactures