



Quality
Experience
Specialization
Reliability
Since 1966



Founded in **1966**, **PARAMINA SA** deals exclusively with compressed air; driven to the **third generation** of ownership as a manufacturer of **screw compressors**, **high pressure piston compressors**,



and **auxiliary compressed air systems** suitable for **Breathing Air** [Firefighting, Marine & Offshore, Defence (Army, Navy, Air Force), Motorsports, Oil & Gas, Diving] as well as **Industrial/General Purpose Air, Gas** (Nitrogen, Helium, Argon) and **Paintball/Shooting Sports** applications.

In December 2005, our company moved to the new facilities, achieving to improve and develop further our products, services and quality control.

In June 2016, **PARAMINA** celebrated its **50 year anniversary**. Five decades of experience and specialization, new ideas and proven reliability of our products, have established PARAMINA as a byword for quality in the compressed air market.

CERTIFICATES



Today, PARAMINA is a company able to respond to all customers' needs, via:

- Extensive and specialized knowledge of our engineers
- 3D Mechanical Design & Engineering
- Robust Manufacturing based on quality, endurance and low operational cost
- Flexibility
- Personal & Direct approach to all customers
- Instant response to all inquiries
- Short & Prompt deliveries
- Rapid & Immediate service support
- Full availability of all spare parts in stock
- Low priced spare parts
- Custom design solutions according to customers demands
- Free sales & service training in our facilities for all our partners
- Quality management system according to EN ISO 9001:2015, certified by TÜV AUSTRIA, for the entire production process, from Research & Development to Manufacturing, Sales and After Sales Services for all our air compressors and air processing equipment. We apply also an environmental system according to EN ISO 14001.
- CE declaration of conformity by independent accredited bodies & compliance with EU directives of all our air compressors and air processing equipment.
- Worldwide Sales & Service network

MISTRAL is Paramina's "petit" mobile high pressure piston compressor. The unit is 3-staged, air cooled and easy to transport due to the built-in wheels.

MISTRAL provides a reliable source of breathing air due to the unique purification system (a coalescing prefilter installed before the active carbon/molecular sieve cartridge - hopcalite as an option). It is **suitable for private divers, small diving shops, diving boats, yachts and small paintball teams.**

MISTRAL's very low turning speed accomplishes low noise level, almost zero vibration and ensures long life operation.

Technical Data

Model	Power	Max. Pressure	FAD		RPM	Dimensions cm			Weight Kg
		bar	m³/h	lit/min		L	W	H	
M6-BZ	3.6kW 4stroke petrol	350	6.2	103	1200	88	41	51	55-65
M6-EM	2.2kW/220-230V/50-60Hz	350	6.2	103	1200	78	41	49	53-73
M6-ET	2.2kW/400-440V/50-60Hz	350	6.2	103	1200	78	41	49	53-73
M8-BZ	4.1kW 4stroke petrol	350	8.4	140	1750	88	41	51	65-73
M8-EM	3kW/220-230V/50-60Hz	350	8.4	140	1750	78	41	49	67-85
M8-ET	3kW/400-440V/50-60Hz	350	8.4	140	1750	78	41	49	67-85

- Oil capacity: 450ml special synthetic compressor oil.
- Permissible ambient temperature: +5 °C to +45 °C.
- ◆ Optional: Classic Version.



Classic ET

Design Specifications

	M6-EM, M8-EM, M6-ET, M8-ET	M6-BZ, M8-BZ
Start/Stop switch	●	■
Micronic air inlet filter	●	●
Pressure maintaining & non return valve for extended filtration	●	●
Condensate Separator after 2nd Stage	●	●
Combined BA Filter including Coalescing Pre-filter (0.5 mg/m³ oil residual) and B.A. cartridge (AC/MS + HP option), with the supply of absolutely clean air exceeding by far the requirements of EN12021	●	●
Safety Bleed valve in case of BA Cartridge absence	◆	◆
Large Stainless Steel Intercoolers - Aftercooler	●	●
Safety Valves in all stages	●	●
Kevlar filling hose (1.2m) with stainless steel fittings and DIN/INT'L connector	●	●
Hourmeter	●	●
Final stage Manometer	●	●
Manual condensate drains	●	●
Motor thermal overload protection	●	■
Automatic belt tensioning system	●	●
Automatic stop system	◆	◆
Automatic start system	◆	■
Automatic condensate drains with manual backups	◆	■
Dual pressure filling facility, allowing 225/330 bar alternative filling	◆	◆
Condensate collecting tank	◆	■
1.5m air inlet hose with particle strainer	◆	●
Special voltage/frequency: 3 x 230 V / 60 Hz - 110 V / 60 Hz	●	■

Not Applicable
Optional
Standard

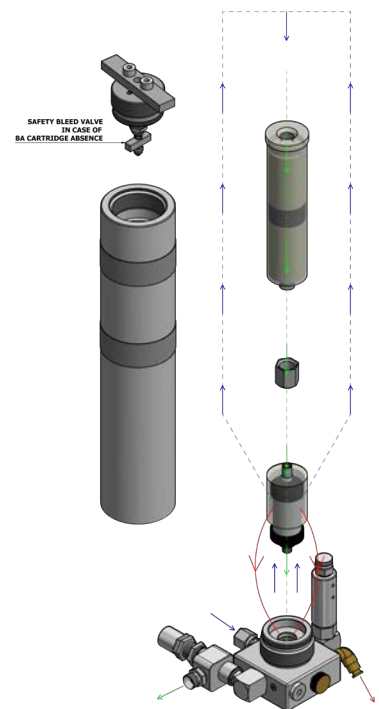

Combined Breathing Air Filter
Ø 80x375



M6/M8 - BZ

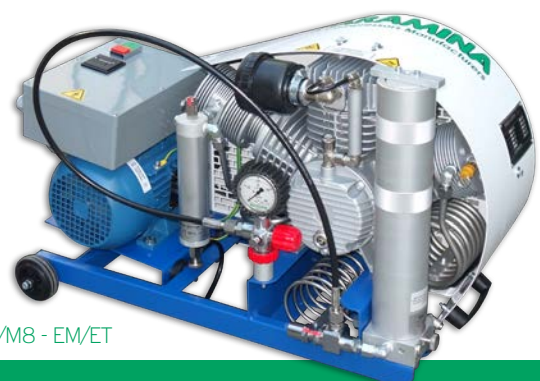

M6/M8 - EM/ET

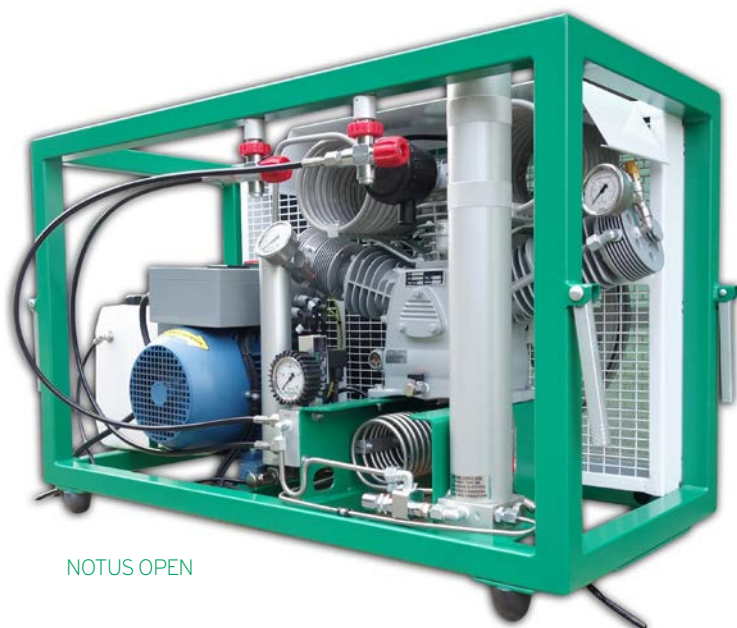

NOTUS OPEN

NOTUS, Paramina's new "Force" in high pressure piston compressor series. Heavy duty design for continuous operation during the day, easy-to-move, 3-staged, oil lubricated and air cooled, offering pure breathing air according to EN 12021.

NOTUS is suitable for indoor or open area installations, mobile rescue squads, fire trucks, diving boats & paintball teams. Its robust construction makes it suitable for several industrial applications as well.

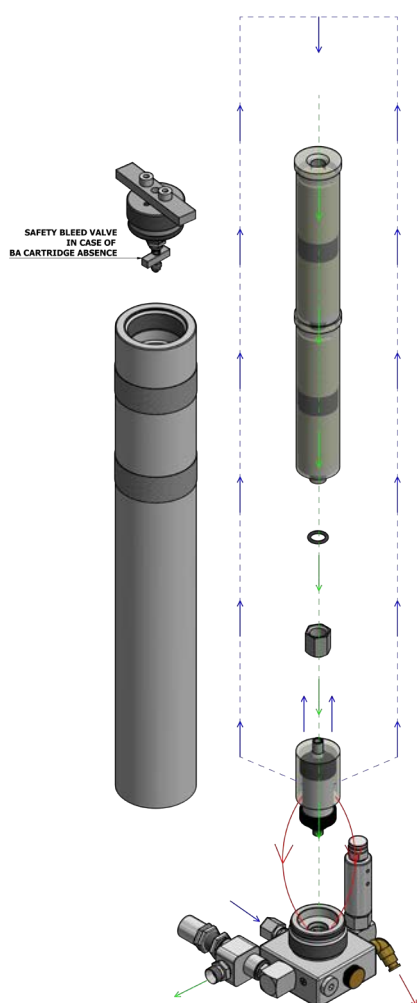

Combined Breathing Air Filter
Ø 80x560



NOTUS CLASSIC

Technical Data

Model	Power	Max. Pressure	FAD		RPM	Dimensions cm			Weight Kg
		bar	m³/h	lit/min		L	W	H	
N10-EM Open	3.7kW/220-230V/50-60Hz	350	10.2	170	1400	110	53	68	113-128
N10-ET Open	4kW/400-440V/50-60Hz	350	10.2	170	1400	110	53	68	129-135
N10-ET Classic	4kW/400-440V/50-60Hz	350	10.2	170	1400	115	53	74	149-155
N10-BZ Open	4.1kW 4stroke petrol	350	10.2	170	1400	110	53	68	86

- Oil capacity: 1.2 lit special synthetic compressor oil.
- Permissible ambient temperature: +5 °C to +45 °C.

Design Specifications

	N10-EM Open	N10-ET Open	N10-ET Classic	N10-BZ Open
Micronic Air Inlet Filter	●	●	●	●
Condensate Separator after 2nd Stage	●	●	●	●
Large Stainless Steel Intercoolers - Aftercooler in all stages	●	●	●	●
Combined BA Filter including Coalescing Pre-filter (0.5mg/m3 oil residual) and 2 x BA cartridges (AC/MS + HP option), with the supply of absolutely clean air exceeding by far the requirements of EN 12021	●	●	●	●
Safety Bleed valve in case of BA Cartridge absence	◆	◆	◆	◆
Pressure maintaining & non-return valve for extended filtration	●	●	●	●
Start/Stop switch	●	●	●	■
Motor thermal overload protection	●	●	●	■
Manual Condensate Drains	●	●	●	●
Kevlar filling hose (1.2m) with stainless steel fittings and DIN/INT'L connector	●	●	●	●
Safety Valves in all stages	●	●	●	●
Final Stage manometer	●	●	●	●
Automatic belt tensioning system	●	●	●	●
Hourmeter	●	●	●	●
Automatic stop system	◆	◆	◆	◆
Automatic start system	◆	◆	◆	■
Automatic condensate drains with manual backups + Condensate collecting tank.	◆	◆	◆	■
Dual pressure filling facility, allowing 225/330bar alternative filling	◆	◆	◆	◆
Star/Delta starter system	■	■	◆	■
Low oil level alarm	■	■	◆	■
High temperature alarm	■	■	◆	■
24VAC secondary voltage providing safety during routine operation	■	■	◆	■
Emergency Stop button	■	■	◆	■
Main Switch	■	■	◆	■
Remote start/stop	■	■	◆	■
Condensate separator after 3rd (final) stage	◆	◆	◆	◆
Interstage manometers	●	●	●	●
1.5m air inlet hose with particle strainer	◆	◆	◆	●
Special voltage/frequency 3x230V/60Hz * 460-480V/60Hz	■	■	◆	■

● Standard | ◆ Optional | ■ Not Applicable



"All Typhoon Electric versions provide automatic stop & automatic condensate drain facility as standard equipment."

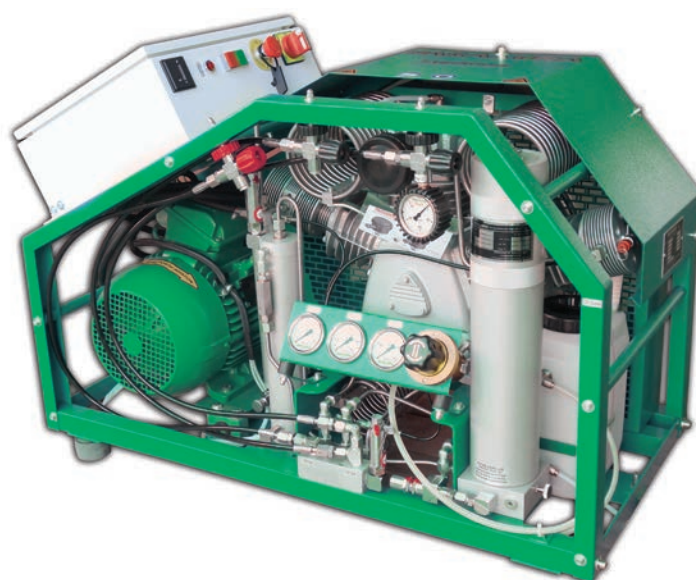
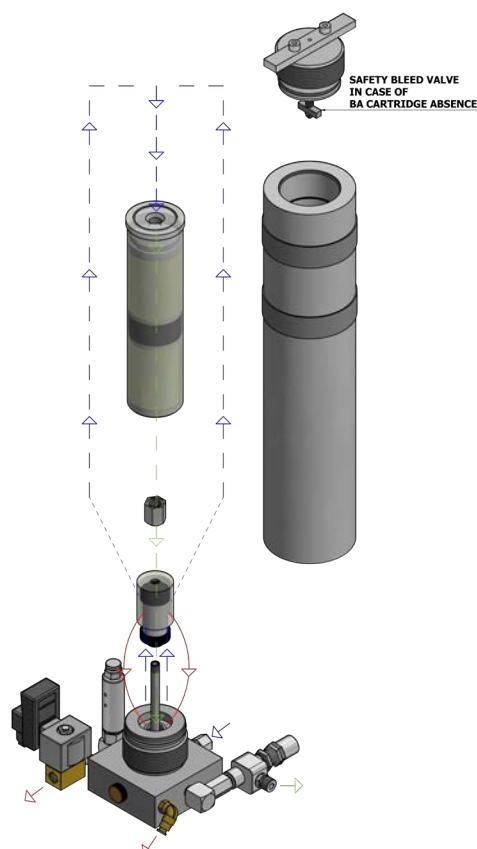

TYPHOON series, 3-staged, air-cooled, high pressure piston compressor, comprising of 15 standard models, with very low turning speed and pure breathing air according to EN 12021, making it **a perfect solution for any breathing air, paint-ball or industrial application**; i.e. fire rescue teams, military units, diving shops, paintball clubs and others.

The series consists of three versions:

- **Open Framed Portable** - With the option of electric motor, petrol and diesel engine for exterior use.
- **Classic Stationary** - With the option of electric motor.
- **Silent** - With soundproof insulation enabling it to operate in areas where the noise level is of issue. Includes digital control panel driving, controlling, protecting and ensuring the safe operation of the compressor.

Technical Data

Model	Power	Max. Pressure	FAD		RPM	Dimensions cm			Weight Kg
		bar	m³/h	lit/min		L	W	H	
Silent 15E *	5.5kW/400-440V/50-60Hz	350/420	15	250	1100	80	98	118	244-260
Silent 18E *	7.5kW/400-440V/50-60Hz	350/420	18/19	300/320	1290/1380	80	98	118	263-269
Open 15E *	5.5kW/400-440V/50-60Hz	350	15	250	1100	109	54	71	185-191
Open 15D	6.8kW Diesel	350	15	250	1100	128	52	73	198-210
Open 15P	6.3kW 4stroke Petrol	350	15	250	1100	128	52	73	169-174
Open 18E	7.5kW/400-440V/50-60Hz	350	18/19	300/320	1290/1380	109	54	71	187-211
Open 18P	8.7kW 4stroke Petrol	350	18	300	1300	128	52	73	187-192
Classic 15E	5.5kW/400-440V/50-60Hz	350/420	15	250	1100	71	125	78	216-232
Classic 18E	7.5kW/400-440V/50-60Hz	350/420	18/19	300/320	1290/1380	71	125	78	226-247
Twin 15E	2x5.5kW/400-440V/50-60Hz	350	2x15	2x250	1100	134	63	172	421-437
Twin 18E	2x7.5kW/400-440V/50-60Hz	350	2x18	2x300	1300	134	63	172	436-456

- Oil capacity: 2.2 lit special synthetic compressor oil.
- Permissible ambient temperature: +5 °C to +45 °C.
- Noise level: Silent 15E - 69 dB(A) @1m, Silent 18E - 70 dB(A) @1m.
- ★ **NEW Economy Versions: Open 13ES, Open 15ES, Silent 15ES, Silent 18ES.**

Design Specifications

	Open/ Classic 15E, 18E	Open/ Classic 15P, 18P, 15D	Silent 15E, 18E	Open Twin 15,18E
Star/Delta starter system	● ¹	■	● ¹	●
Electric Starter/Battery fitted	■	●	■	■
Advanced DIGITAL CONTROLLER providing operation (running hrs, filling pressure, operating temperature), control (start/stop/reset/menu button) & service (service hrs-alarm, records of the last 15 malfunctions) data	■	■	●	■
Oil pump lubrication	◆	◆	◆	◆
Start/Stop switch	●	■	■	●
Motor thermal overload protection	●	■	●	●
Automatic stop system	●	◆	●	●
Automatic start system	◆	■	●	◆
Automatic condensate drains with manual backups + Condensate collecting tank.	●	◆	●	●
24V secondary voltage providing safety during routine operation	●	■	●	●
Emergency Stop button	●	■	●	●
Micronic air inlet filter	●	●	●	●
Pressure maintaining & non return valve for extended filtration	●	●	●	●
Condensate Separator after 2nd Stage	●	●	●	●
Combined BA Filter including Coalescing Pre-filter (0.5 mg/m ³ oil residual) and BA cartridge (AC/MS + HP option), with the supply of absolutely clean air exceeding by far the requirements of EN12021	● ²	● ²	● ²	● ²
Safety Bleed valve in case of BA Cartridge absence	◆	◆	◆	◆
Large Stainless Steel Intercoolers - Aftercooler	●	●	●	●
Safety Valves in all stages	●	●	●	●
Interstage pressure sensors providing emergency shutdown in case of overpressure	◆	■	●	◆
2 Kevlar filling hoses (1.2m each) with stainless steel fittings and DIN/INT'L connectors	●	●	●	■
Lever operated on/off filling valves with automatic ventilation	◆	◆	●	■
Soundproof insulation ensuring very low noise level	■	■	●	■
Dual pressure filling facility, allowing 225/330 bar simultaneous filling via pressure regulator	◆	◆	◆	■
Remote Start/Stop - Remote Load/Unload	◆	■	●	◆
Interstage/Final stage Manometers	●	●	●	●
Hourmeter	●	●	●	●
High Temperature alarm	◆	◆	●	◆
Low Oil level alarm	◆	◆	◆	●
Final stage Condensate Separator	◆	◆	◆	◆
Special Voltage/Frequency: 230V/50Hz-60Hz * 3x230V/60Hz * 460-480V/60Hz	◆	■	◆	◆
Voltage failure and Phase Rotation Safety device	◆	■	◆	◆
Automatic belt tensioning system	●	●	●	●
1.5m air inlet hose with particle strainer	◆	●	◆	◆



Open Twin

Not Applicable

■

Optional

◆

Standard

●

¹ Standard on Typhoon 18 models - option on Typhoon 15 models.

² Ø80 x 560 Typhoon 15 models, Ø110 x 495 Typhoon 18 models (option for Typhoon 15 models). Ø110 x 725 Typhoon Open Twin 15E & 18E.



Classic



Open "P"



TYPHOON CLASSIC 18
DIESEL TROPICAL

Typhoon Tropical series, 3-staged/air-cooled/high pressure piston compressor, ensuring safe operation and pure breathing air quality acc. to EN 12021 directive, even in contaminated environment via CO, H₂S, H₂O monitoring and alarm.

- Heavy Duty Design.
- Extreme Operating Conditions.
- Tropical version for high ambient temperatures (50°C max) and increased humidity environment.



TYPHOON CLASSIC 18
ELECTRIC TROPICAL

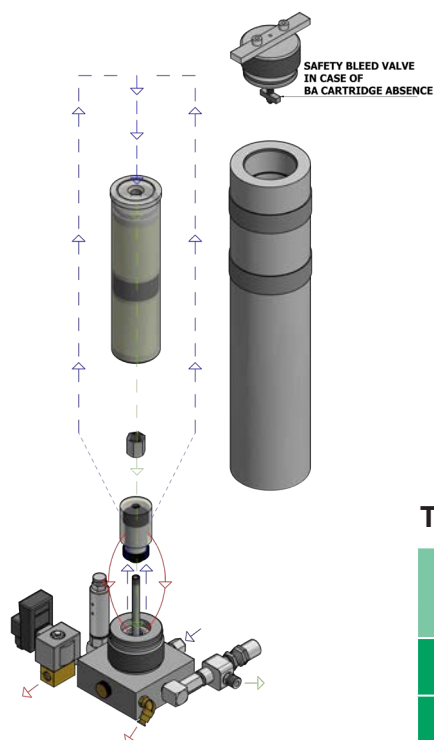

Combined Breathing Air Filter
Ø 110 x 495

Dual Pressure
200 & 300 bar Filling



Technical Data

Model	Power	Max. Pressure	FAD		RPM	Dimensions cm			Weight Kg
		bar	m ³ /h	lit/min					
Typhoon Classic 18E TROPICAL	9.2kW/400-440V/50-60Hz	350	19.2	320	1370	152	81	107	339
Typhoon Classic 18D TROPICAL	11.2kW Hatz Diesel	350	19.2	320	1370	142	74	102	398

- Oil capacity: 2.3 lit special synthetic compressor oil.
- Permissible ambient temperature: +5 °C to +50 °C.

Design Specifications

	Typhoon Classic 18E TROPICAL	Typhoon Classic 18D TROPICAL
Star/Delta starter system	●	■
Electric Starter/Battery fitted	■	●
Advanced DIGITAL CONTROLLER providing operation (running hrs, filling pressure, operating temperature), control (start/stop/reset/menu button) & service (service hrs-alarm, records of the last 15 malfunctions) data	◆	■
Oil pump lubrication	●	●
Lifting eyebolts for easier transportation	●	●
Galvanized & powder Coated frame and covers	●	●
Maintenance Vibration Hourmeter	●	●
Carbon Monoxide (CO) monitoring / alarm system	●	●
Hydrogen Sulfide (H2S) monitoring / alarm system	●	●
Humidity (H2O) monitoring / alarm system	●	●
Voltage Failure & Phase Rotation Safety Device	●	■
Start/Stop switch	●	●
Motor thermal overload protection	●	■
Automatic stop system	●	●
Automatic start system	◆	■
Automatic condensate drains with manual backups	●	●
24V secondary voltage providing safety during routine operation	●	■
Emergency Stop button	●	■
Micronic air inlet filter	●	●
Pressure maintaining & non return valve for extended filtration	●	●
Condensate Separators in all stages	●	●
Combined BA Filter including Coalescing Pre-filter (0.5 mg/m3 oil residual) and BA cartridge (AC/MS + HP option), with the supply of absolutely clean air exceeding by far the requirements of EN12021	●	●
Safety Bleed valve in case of BA Cartridge absence	◆	◆
Large Stainless Steel Intercoolers - Aftercooler	●	●
Safety Valves in all stages	●	●
Interstage pressure sensors providing emergency shutdown in case of overpressure	◆	■
2 Kevlar filling hoses (1.2m each) with stainless steel fittings and DIN/INT'L connectors	●	●
Lever operated on/off filling valves with automatic ventilation	●	●
Dual pressure filling facility, allowing 225/330 bar simultaneous filling via pressure regulator	◆	◆
Remote Start/Stop - Remote Load/Unload	◆	■
Interstage/Final stage Manometers	●	●
High Temperature alarm	●	●
Low Oil level alarm	●	●
Condensate collecting tank	●	●
Special Voltage/Frequency: 230V/50Hz-60Hz * 3x230V/60Hz * 460-480V/60Hz	◆	■
Automatic belt tensioning system	●	●
1.5m air inlet hose with particle strainer	●	●

● Standard | ◆ Optional | ■ Not Applicable

"All Cyclone models are fully automated and provide 4-stages compression"

CYCLONE, the Silent Force. **4-staged, air cooled, high pressure piston compressor**, combining low turning speed operation, soundproof insulated doors, optimum cooling system, and easy-to-use digital control panel, providing smooth, safe, quiet and long life operation. Easy access through large openings ensuring quick maintenance.

The multi stage purification system guarantees absolute clean air, making it **applicable in** numerous breathing air sectors including **fish farms, military, fire brigades** and **diving centers**.

Technical Data

Model	Power	Max. Pressure	FAD		RPM	Dimensions cm			Weight
		bar	m³/h	lit/min	min¹	L	W	H	Kg
Silent 24E	7.5kW/400-440V /50-60Hz	350/420	24	400	700	81	124	178	498-510
Silent 30E	11kW/400-440V /50-60Hz	350/420	30	500	900	81	124	178	549-556
Silent 36E	15kW/400-440V /50-60Hz	350/420	36	600	1000	81	124	178	551-585

- Oil capacity: 2.8 lit special synthetic compressor oil.
- Permissible ambient temperature: +5 °C to +45 °C.
- Noise level: C. Silent 24 - 72 dB(A) @1m, C. Silent 30 - 73 dB(A) @1m, C. Silent 36 - 75 dB(A) @1m.

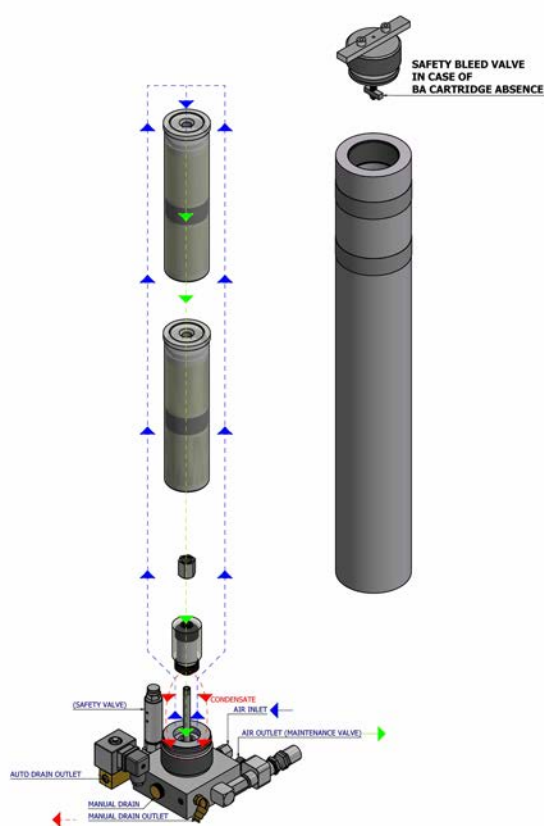

Combined Breathing Air Filter
Ø 110 x 725



Design Specifications

	CYCLONE 24	CYCLONE 30	CYCLONE 36
Star/Delta starter system	●	●	●
Advanced DIGITAL CONTROLLER providing operation (running hrs, filling pressure, operating temperature), control (start/stop/reset/menu button) & service (service hrs-alarm, records of the last 15 malfunctions) data	●	●	●
Oil pump lubrication	◆	◆	◆
Automatic control of start/stop system	●	●	●
Automatic condensate drains with manual backups + Condensate collecting tank	●	●	●
24V secondary voltage providing safety during routine operation	●	●	●
Emergency Stop button	●	●	●
Main Switch	●	●	●
Micronic air inlet filter	●	●	●
Pressure maintaining & non return valve for extended filtration	●	●	●
Condensate Separators after 1st, 2nd, 3rd and final stage	●	●	●
Combined BA Filter including Coalescing Pre-filter (0.5 mg/m ³ oil residual) and 2 large BA cartridges (AC/MS + HP option), with the supply of absolutely clean air exceeding by far the requirements of EN12021	●	●	●
Safety Bleed valve in case of BA Cartridge absence	◆	◆	◆
High efficiency aluminium cooler (1st & 2nd stage)	●	●	●
Large Stainless Steel Intercooler - Aftercooler (3rd & 4th stage)	●	●	●
Safety Valves in all stages	●	●	●
Interstage pressure sensors providing emergency shutdown in case of overpressure	●	●	●
Secondary large fan with independent electric motor for optimum cooling (630mm diam.)	●	●	●
5 Kevlar filling hoses (1.2m each) with stainless steel fittings and DIN/INT'L connectors	●	●	●
Lever operated on/off filling valves with automatic ventilation	●	●	●
Soundproof insulation ensuring very low noise level	●	●	●
Dual pressure filling facility, allowing 225/330 bar simultaneous filling via pressure regulator	◆	◆	◆
Remote Start/Stop - Remote Load/Unload	●	●	●
Interstage/Final stage Manometers	●	●	●
High Temperature alarm	●	●	●
Low Oil level alarm	●	●	●
Special Voltage/Frequency: 230V/50-60Hz * 3x230V/60Hz * 460-480V/60Hz	◆	◆	◆
Voltage failure and Phase Rotation Safety device	◆	◆	◆
Automatic belt tensioning system	●	●	●

● Standard | ◆ Optional

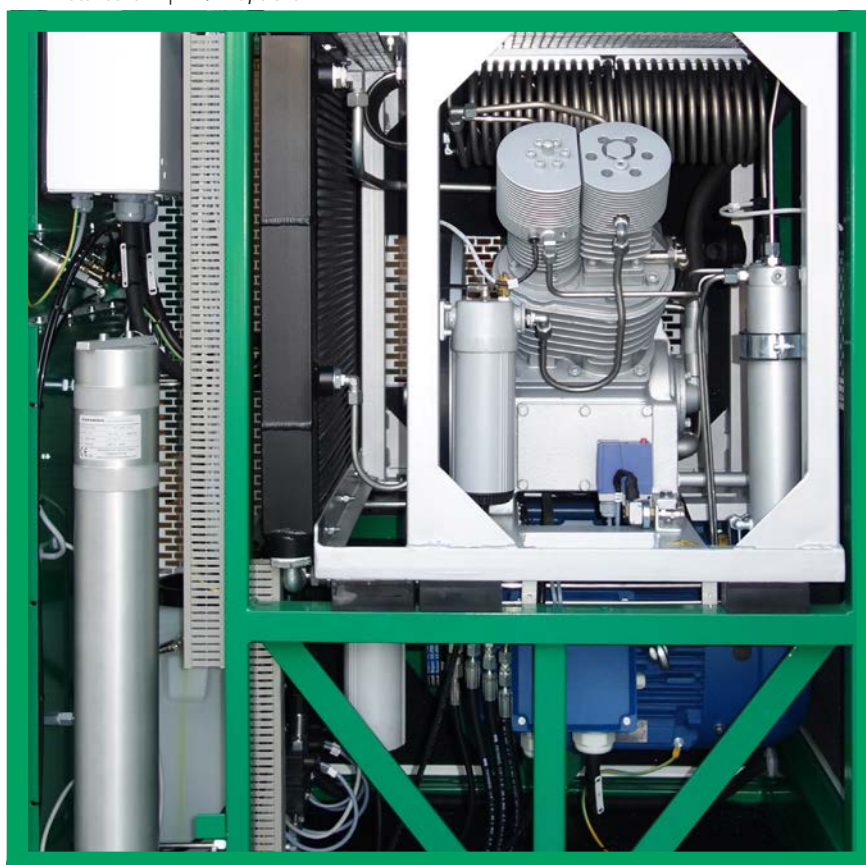
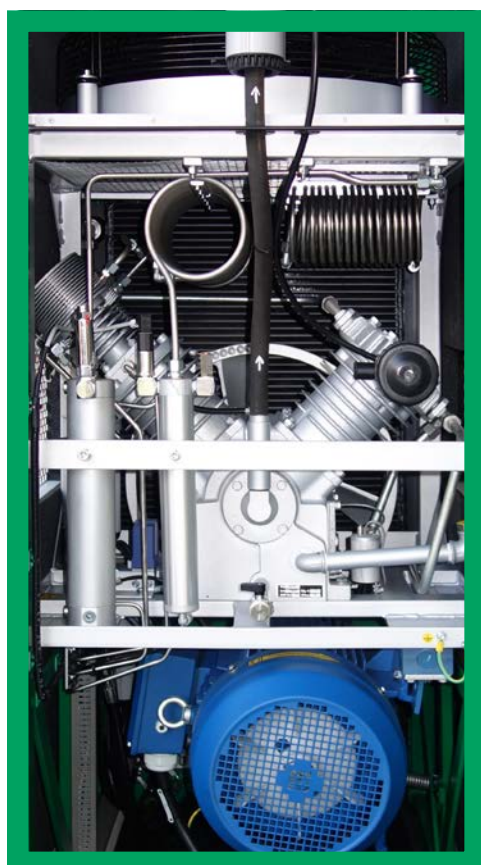

*“Tailor-made
solutions
for each
individual Gas
installation”*

High-pressure piston **GAS** compressors, suitable for **NITROGEN (N₂)**, **Helium (He)** & **Argon (Ar)** applications; Compact or Silent, 3+4-staged, air cooled, oil lubricated, with Zero Loss drain system.

Technical Data

Model	Power	Max. Pressure	FAD		Dimensions cm			Weight
		bar	m ³ /h	lit/min	L	W	H	Kg
Mistral M6-ET Classic	2.2kW/400-440V/50-60Hz	350	6.6	110	94	55	70	120
Notus N10-ET Classic	4kW/400-440V/50-60Hz	350	10.2	170	110	55	68	146
Typhoon Classic 18E	7.5kW/400-440V/50-60Hz	350	19.2	320	71	125	78	250-261
Typhoon Silent 18E	7.5kW/400-440V/50-60Hz	350	19.2	320	80	98	118	280
Cyclone Silent 30E	11kW/400-440V/50-60Hz	350	30	500	81	124	178	567-582
Cyclone Silent 36E	15kW/400-440V/50-60Hz	350	36	600	81	124	178	594-603



Mistral
Gas



Notus Gas

Design Specifications

Inlet Solenoid valve
Inlet Pressure regulator
2 x Inlet pressure safety valves
Inlet Pressure Manometer
Inlet Pulsation chamber
Inlet Safety Pressure Switch
Inlet Vacuum Safety Pressure Switch
Oversized Stainless Steel Intercoolers & Aftercooler in all stages for optimum cooling
Advanced Design Cylinder Heads for optimum heat discharge
Safety Valves in all stages
Interstage and Final stage Condensate Separators
Final Gas Purification Filter, including coalescing prefilter (0.5 mg/m ³ oil residual) and 2x large AC/MS cartridges
Large fan for high efficiency cooling of cylinders, intercoolers & aftercoolers, making the compressor capable for continuous operation
Secondary fan with independent electric motor for extra cooling (available only for Cyclone Silent model)
Zero Loss Automatic Condensate Drain system via condensate return piping system, back inside compressor's crankcase
Star/Delta starter system
24V secondary voltage providing safety during routine operation
Main Switch
Emergency Stop button
Advanced DIGITAL CONTROLLER (available only for Typhoon Silent and Cyclone Silent models)
Automatic Start/Stop system at the desirable pressure
Interstage pressure control with pressure sensors in all stages (available only for Typhoon Silent and Cyclone Silent models)
High temperature alarm & shutdown error
Oil pump lubrication (Optional)
Low Oil level sensor alarm & shutdown error
Hourmeter
Motor thermal overload protection
Voltage failure and Phase Rotation Safety device
Interstage and Final Stage Manometers
Built-In Vibration Pads
Non return valve before the outlet
Automatic belt tensioning system
Soundproof insulation (available only for Typhoon Silent and Cyclone Silent models)

Cyclone Gas



Typhoon Classic Gas



MIDDLE PRESSURE COMPRESSORS

Middle-pressure piston compressors, suitable for any INDUSTRIAL application; Open Framed, 2-staged, air cooled, oil lubricated.
Models: Mistral & Typhoon.

Technical Data

Model	Power	Max. Pressure	FAD		Dimensions cm			Weight
		bar	m³/h	lit/min	L	W	H	Kg
Mistral M6-ET 40b	2.2kW/400-440V/50-60Hz	40	10	166	74	40	48	60
Typhoon Open 15E 40b	5.5kW/400-440V/50-60Hz	40	24	400	109	54	71	185-190
Typhoon Open 18E 40b	7.5kW/400-440V/50-60Hz	40	30	500	109	54	71	190-195

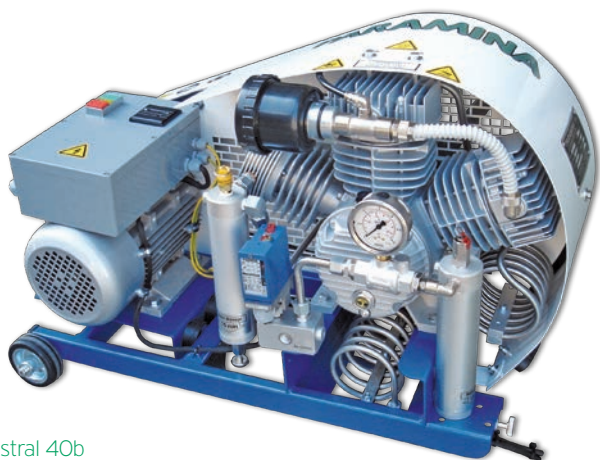

Mistral 40b

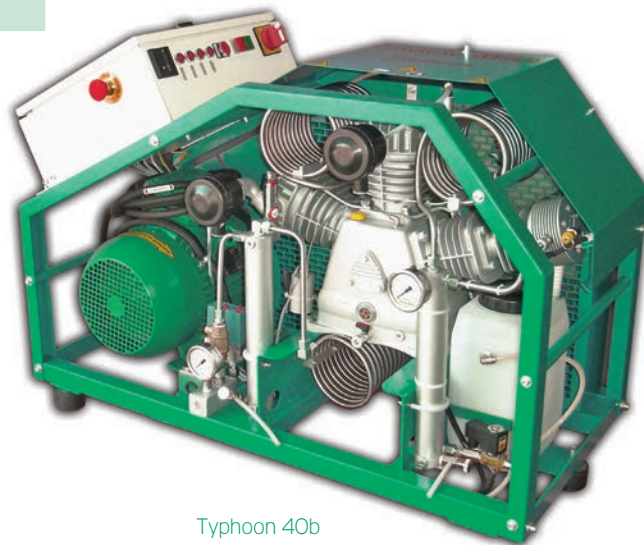

Typhoon 40b

REFRIGERATED DRYER "CRYO"

HPRD 600

Model	Power	Max. Working Pressure	Capacity		Dimensions cm			Weight
		bar	m³/h	lit/min	L	W	H	Kg
HPRD600	230V AC / 50-60Hz	350/420	36	600	53	58	48	43

- +3 °C dew point.
- R134a CFC Free refrigerant.



HUMIDITY CONTROL SYSTEM

Model	Power	Max. Working Pressure	Dimensions cm			Weight
		bar	L	W	H	Kg
HC	230VAC 50-60Hz or 24VAC 50-60Hz or 24VDC	420	12.3	20	11.2	2.2

- Accurate humidity sensor in stainless steel chamber.
- Central monitoring unit with digital display.



HC

STORAGE SYSTEMS

- Powder coated steel frame
- 50/80 lit. Cylinders
- Working Pressure up to 450 bar
- Custom design availability



FILTER PANELS

- Wall mounted powder coated steel frame
- BA Filter(s) (Coalescing Prefilter & BA cartridges)
- Manual and/or Automatic condensate drains

FILLING PANELS

- Breathing air filling panels
- Automatic priority filling panels
- Paintball filling panels
- Custom design availability



- Kevlar filling hoses with lever operated filling valves
- Dual pressure filling facility 225/330 bar
- Powder coated steel frame

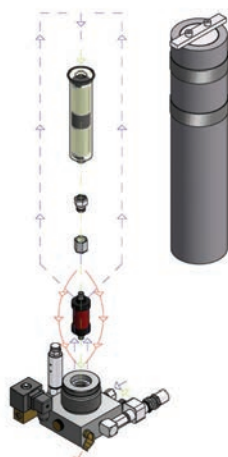

COMBINED
BREATHING AIR
FILTERS



CONDENSATE
SEPARATORS



KEVLAR
FILLING HOSES

DIN200/300
FILLING
CONNECTORS &
YOKE ADAPTORS



ADAPTOR
DIN300 TO
DIN200



LEVER
FILLING
VALVES



PRESSURE
MAINTAINING
VALVES



SAFETY
VALVES





We are proud of our consistent

- ✓ Product Quality
- ✓ Experience
- ✓ Specialization
- ✓ Reliability

now spanning over 50 years!



PARAMINA SA

Byway Evagelistrias str.,
19300 Aspropirgos, Greece
Tel: +30 210 5575860-1, Fax: +30 210 5575868
www.paramina-compressors.com
info@paramina.gr